

## The Complete Wall & Column Formwork Solution



***Safer / Faster / Greener / Sustainable***  
***'One system, endless possibilities'***

[www.fastformsystems.com](http://www.fastformsystems.com)

# Fast-Form™ the benefits

**ECONOMY:** Faster than traditional timber forms and a cost effective alternative to panel systems.

A unique system that can be used as a hand fit system BUT can also be moved in large panels by cranes, when erected it looks like and is as strong as any panel system but without the joints.

You get the benefit of a lightweight hand fit system and the speed of a large panel system with the finish of a timber system as our system is faced with plywood with NO JOINTS!.

CRANES ARE NOT NEEDED (When used as a Hand Fit System).

British designed and manufactured by a British company, BUY BRITISH get BRITISH QUALITY!

Need handrails or access platforms? they are easily attached and as they are part of our formwork system you don't need a scaffolder to erect them which is an additional cost saving.

Our system will save you days or weeks on your program and thousands of pounds in plant hire. Timber can be completely eliminated with the use of our plastic ply options.

**SAFETY:** When timber forms are used, where are the structural calculations? How does the risk assessment cover there being no handrail or access? The simple answer is timber does not offer these and in real terms it is an unsafe method of working in most applications.

Fast-Form™ helps you meet manual handling regulations with no part more than 25kg. Fast-Form™ handrail & access systems conform to the HSE working at height regulations.

**ENVIRONMENTAL:** There is generally a lot of timber wastage with timber formwork. Fast-Form™ can not only reduce timber usage, but with new plastic ply's it can totally eliminate timber usage with fully recyclable materials that are much stronger and safer than timber products.

## KEY BENEFITS:

- **SAFETY:** Access, handrails & toe boards, no crane required in most applications. lightweight system that can be lifted by hand or moved by crane in panels if required
- **SPEED:** Less make up, no de-nailing, lightweight and easy to use system much faster than traditional methods and very simple to use
- **COST:** Less expensive than any other system or timber with reduced labour and plant costs, no waste skips required and very little material waste
- **ENVIRONMENTAL:** Little or no timber wastage and 100% fully recyclable materials, greatly reduced Carbon emissions from not only our system but also reduced emissions from deliveries
- **BETTER FINISH:** Fair face finishes are easily achieved, we offer the best finish on the market with an F4 finish achievable meaning less remedial works, ply fixed from behind system
- **BESPOKE FORMWORK:** As a manufacturer we can provide a solution for almost anything and specialise in bespoke design and manufacture

**For in-depth information on all our systems please visit our websites:**

[www.fastformsystems.com](http://www.fastformsystems.com) (All Formwork products)

[www.roadforms.com](http://www.roadforms.com) (Road Forms & accessories)

[www.sheetpilecappingsystem.co.uk](http://www.sheetpilecappingsystem.co.uk) (Sheet Pile Capping)

[www.formwork-sales.com](http://www.formwork-sales.com) (Formwork accessories & sales)

# Fast-Form Wall Formwork System

Fast-Form is the perfect solution for all types of wall and column formwork, our unique Patented design offers all the strength of a steel panel system with the flexibility and ease of use of a hand fit system and the finish of a traditional timber system. No other system offers such flexibility.

**Free design service, full structural calculations & 3D temporary works drawings included.**

Unlike panel systems Fast Form has no unsightly joints so is ideal for fair face finishes and an F4 finish is easily achieved. The same components can also be used for straight or radius walls and columns. Our unique system needs NO KICKERS, can be adjusted for uneven ground and can be angled / battered because of its unique adjustable feet that bolt down to the slab.



Our system comes in a range of sizes and widths and unlike panel systems it does not need any timber infills or have hundreds of components to lose or damage, with the only loose parts being low cost nuts and bolts. (Ply is fixed from behind so you get a flawless face finish!)

When you look at the system you can be forgiven for thinking its just like any other panel system and of course once erected it does look similar BUT its the way in which our system is assembled that makes the difference and although you may think it looks time consuming to bolt together it is in fact extremely quick, all systems need assembly of some sort and ours is quick and easy to use. Our Aluminium system comes ready assembled so there is no make up at all.

You erect our system by hand to almost any height, see our website for a case study on Googles new headquarters for You Tube in London where a 22m long X 11m wide wall 6.4m high was cast in a single pour, it had in internal wall, floors and lift shafts and was on the 3rd floor of an existing building, so not only did it have to be erected by hand it had to be carried in by hand!

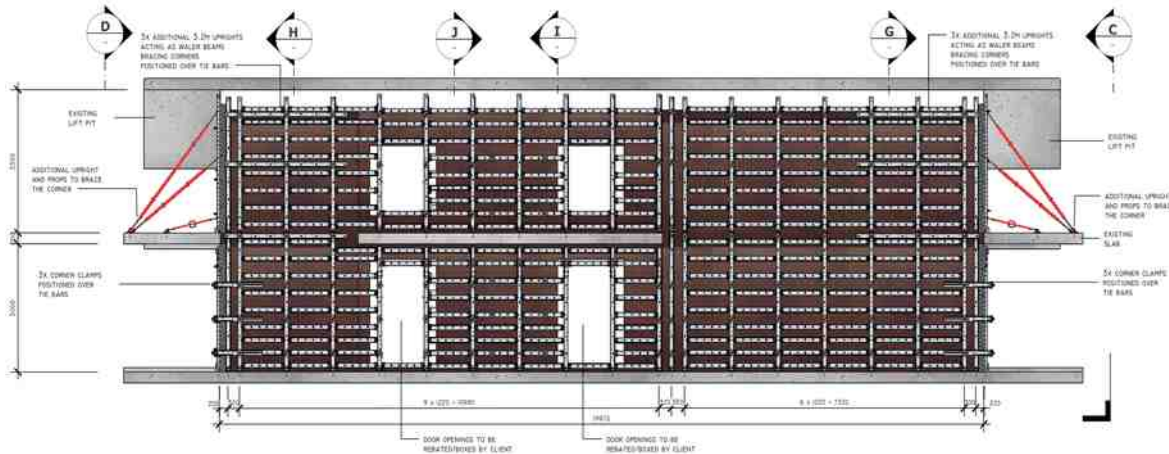

Standard heights are .8m / 1.2m\* / 1.9m / 2.4m / 3.2m but all can be joined to almost any height, our standard alignment props take the system to 6.4m but we can go to 10m plus, our standard widths are 450mm / 600mm / 900mm and 1220mm. \* Aluminium only

Our unique tie holes ALWAYS line up and you need less ties than most panel or timber systems, meaning less remedial works, we can pour to 1.8m with no tie bars.

The unique way our system is assembled means we can add or move pieces to accommodate for pipes / openings or to strengthen the system for single sided pours with NO A-FRAMES!.

Our system also comes in a choice of our lightweight galvanised Steel or super lightweight Aluminium. Both can also be mixed and can also be used for column formwork. Hand fit or Crane lift-able from the same system.

**Fast-Form Saves Time, Money and Carbon emissions**, Carbon use is reduced by 80 to 100% against timber forms and 60% against other panel systems.

**Fast Form is quick, efficient & less expensive overall.**



## WALL SYSTEM (DOUBLE SIDED) - QUICK INSTALLATION GUIDE

STEP 1



MARK A LINE ALONG CONCRETE POUR, DRILL A HOLE AND FIX FIRST UPRIGHT WITH PROPS.

STEP 2



REPEAT THE PROCESS FOR NEXT UPRIGHT USING INTERMEDIATE BRACES TO SET THE DISTANCE APART. FIX TOP AND BOTTOM INTERMEDIATE BRACE.

STEP 3



FILL IN REMAINING INTERMEDIATE BRACES.

STEP 4

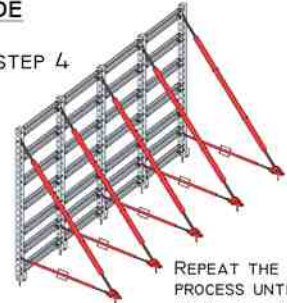

REPEAT THE PROCESS UNTIL ALL UPRIGHTS ARE FIXED

STEP 5



FIX PLYWOOD FROM BEHIND MAKING SURE THE JOINTS LAND ON UPRIGHT CENTRES.

STEP 6

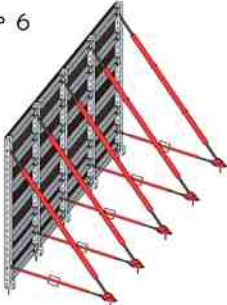

ONCE ALL PLYWOOD IS FIXED, LINE IN AND PLUMB UP THE PANEL.

STEP 7

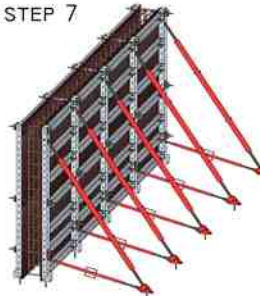

FIX OPPOSITE UPRIGHTS USING THE SAME STEPS. POSITION TIE BARS THROUGH THE SYSTEM, SECURING THEM USING PLATES AND SPINNERS.

STEP 8

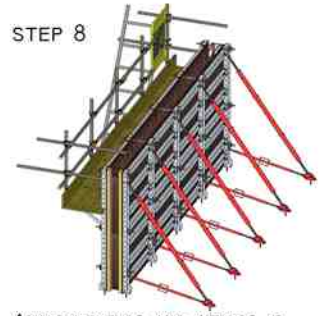

ADD STOP-ENDS AND ACCESS IF REQUIRED. ONCE ASSEMBLED PANELS CAN BE LIFTED IN SECTIONS [SEE 'STEEL WALERS & LIFTING ATTACHMENT' FOR MORE DETAILS]

### UPRIGHT INTERMEDIATE BRACE SIZES

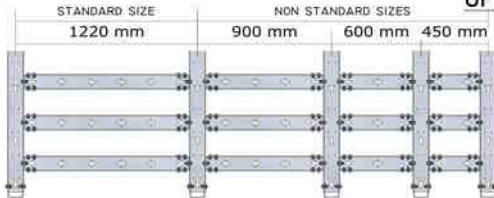

ALL INTERMEDIATE BRACE SIZES ARE MEASURED FROM CENTRE TO CENTRE OF AN UPRIGHT.

ALL INTERMEDIATE BRACE SIZES ARE AVAILABLE IN 1.9M, 2.4M AND 3.2M SYSTEM HEIGHTS.

NON STANDARD INTERMEDIATE BRACE SIZES TO BE USED WHEN A FULL STANDARD PANEL DOES NOT FIT REQUIRED LENGTH.

\*ALUMINIUM WALL SYSTEM COMES IN READY MADE 610 & 1220MM PANELS AND JUST ARE BOLTED TOGETHER.\*

DOUBLE SIDED WALL SYSTEM - (TIE BAR ARRANGEMENT SHOWN)

SINGLE SIDED WALL SYSTEM - (PROPS ARRANGEMENT SHOWN)

INTERMEDIATE BRACE SPACING

WALL SYSTEM (DOUBLE SIDED) - TYPICAL CORNER

#### 1940MM WALL SYSTEM

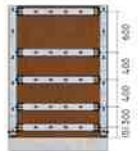
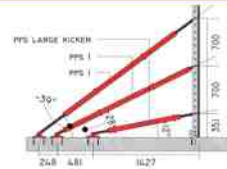
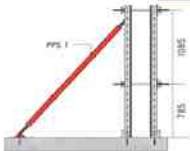

#### 2440MM WALL SYSTEM

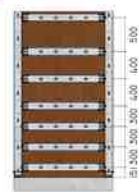
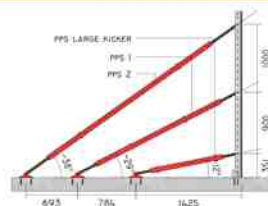
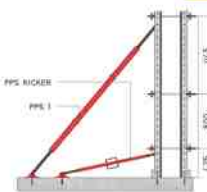

#### 3240MM WALL SYSTEM

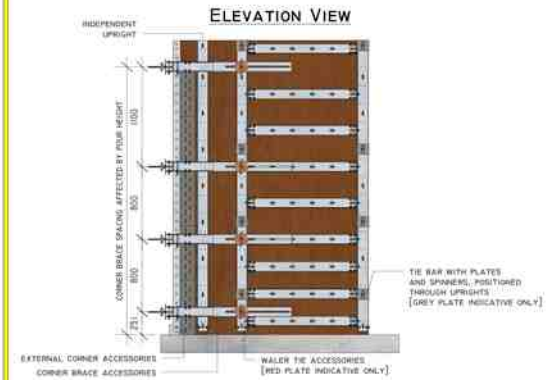
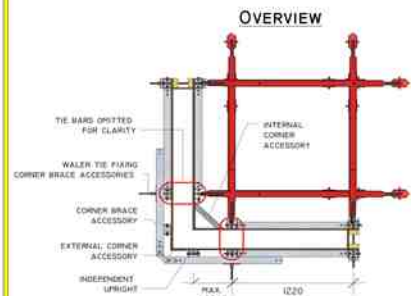
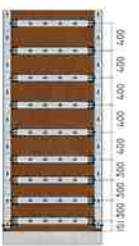
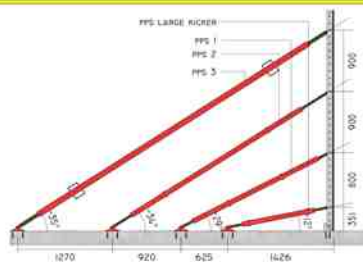
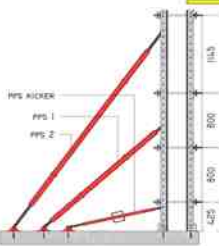

PLEASE NOTE THIS GUIDE IS NOT TO BE USED FOR CONSTRUCTION  
ALWAYS ASK FOR A DETAILED, CERTIFIED CONSTRUCTION DRAWING BEFORE ASSEMBLING YOUR SYSTEM

Please just call or visit our website:  
[www.fastformsystems.com](http://www.fastformsystems.com)

## ALUMINIUM WALL SYSTEM (DOUBLE SIDED) - QUICK INSTALLATION GUIDE

STEP 1



DRILL A HOLE AND FIX FIRST PANEL WITH PROPS TO YOUR LINE OF SHUTTER.

STEP 2



FIX PLYWOOD MAKING SURE PLYWOOD SPANS FROM EDGE TO EDGE OF UPRIGHTS [OPTIONAL PLYWOOD CAN BE FITTED TO PANELS PRIOR TO ERECTION].

STEP 3



CONNECT SECOND PANEL TO THE FIRST ONE [SEE BELOW FOR PANEL JOINING DETAIL].

STEP 4

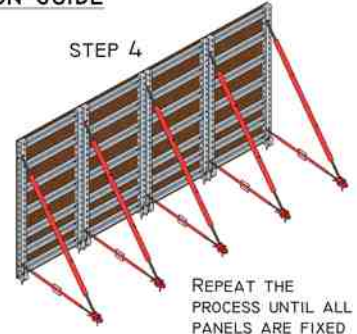

REPEAT THE PROCESS UNTIL ALL PANELS ARE FIXED.

STEP 5

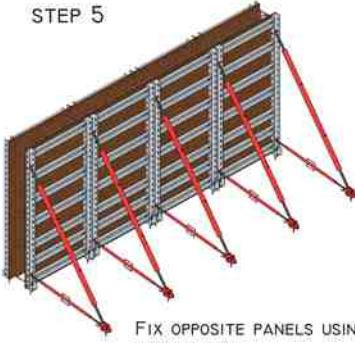

FIX OPPOSITE PANELS USING THE SAME STEPS.

STEP 6

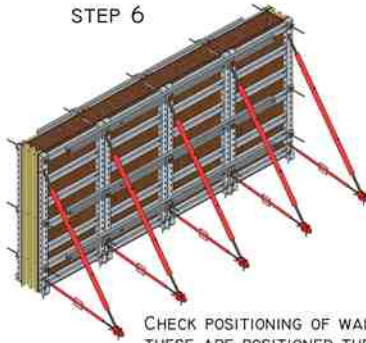

CHECK POSITIONING OF WATER BEAMS. IF THESE ARE POSITIONED THROUGH THE TIE BARS, SECURE THEM USING PLATES AND SPINNERS. ADD STOP-ENDS.

STEP 7

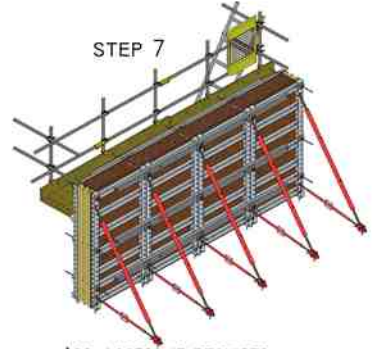

ADD ACCESS IF REQUIRED.

### ALUMINIUM PANEL JOINING DETAIL



ADDITIONAL M16x35MM TENSILE BOLT USED TO JOIN ALUMINIUM PANELS TOGETHER

M16x140MM BOLT INDICATING POSITIONING OF KICKER PROP (OMITTED FOR CLARITY)

M16x35MM TENSILE BOLT JOINING TWO FEET TOGETHER

1X CONCRETE BOLT PER UPRIGHT'S FOOT

### ALUMINIUM WALL SYSTEM PANEL RANGE (INTERMEDIATE BRACE SPACING SHOWN)

1220x2440MM  
PANEL

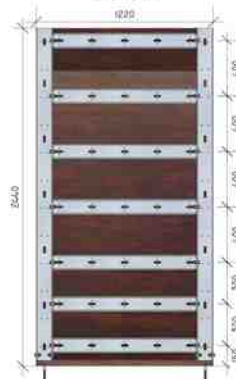

610x2440MM  
PANEL

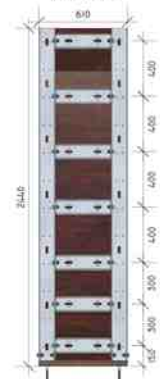

1220x1220MM  
PANEL



610x1220MM  
PANEL

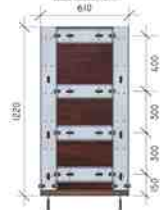

### WALL SYSTEM (DOUBLE SIDED) - TYPICAL CORNER

OVERVIEW

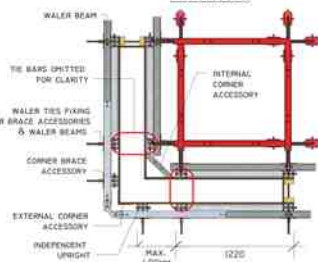

ELEVATION VIEW

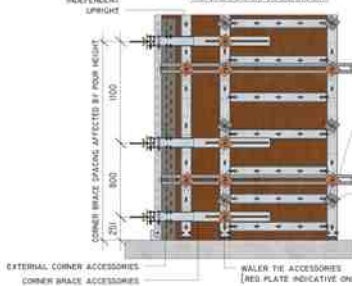

### ALUMINIUM JOINING CHANNEL



ALUMINIUM JOINING CHANNEL IS USED TO FIX PANELS TOGETHER TO INCREASE POUR HEIGHT.

PLEASE NOTE THIS GUIDE IS NOT TO BE USED FOR CONSTRUCTION  
ALWAYS ASK FOR A DETAILED, CERTIFIED CONSTRUCTION DRAWING BEFORE ASSEMBLING YOUR SYSTEM

Please just call or visit our website:  
[www.fastformsystems.com](http://www.fastformsystems.com)



**2.4m wall system with full access and handrails**

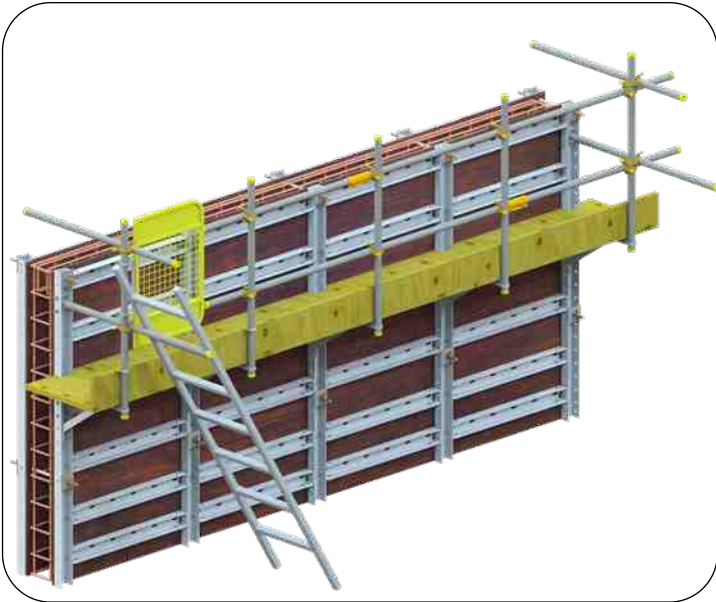

**Radius wall system from same wall components as straight walls**

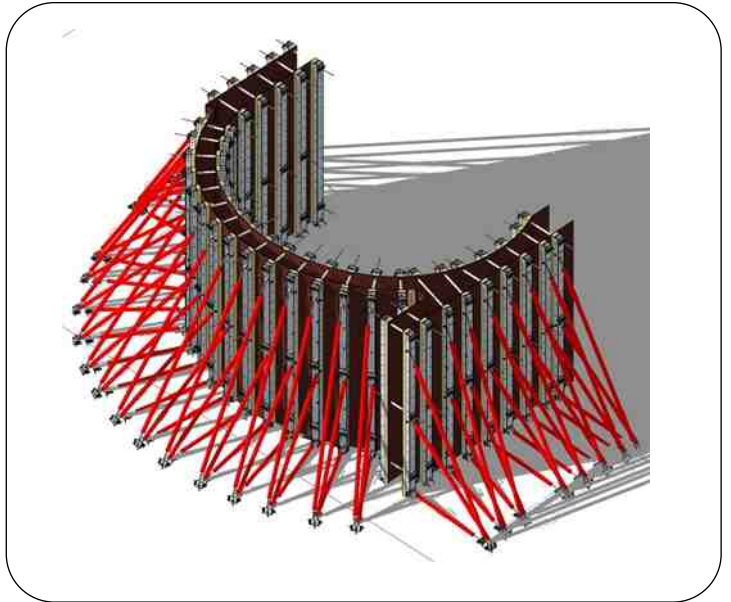

**Lifting in large panels using our waler beams and lifting eyes**

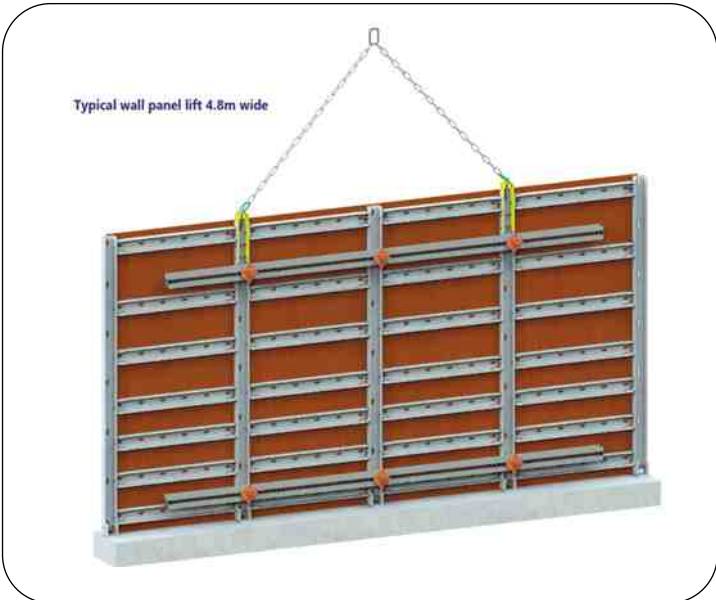

**Columns from 200mm wide and from 1.9m to 6.4m high**

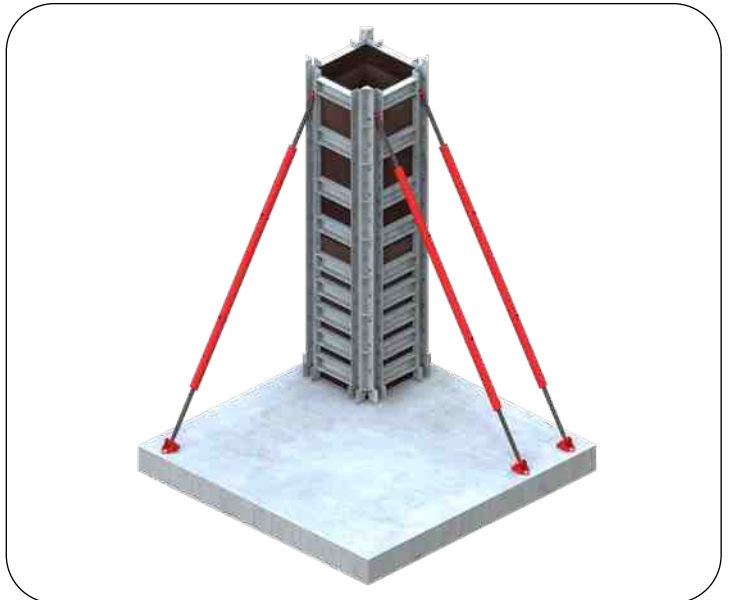

**M6 Smart motorway 6m full height bridge encapsulation**

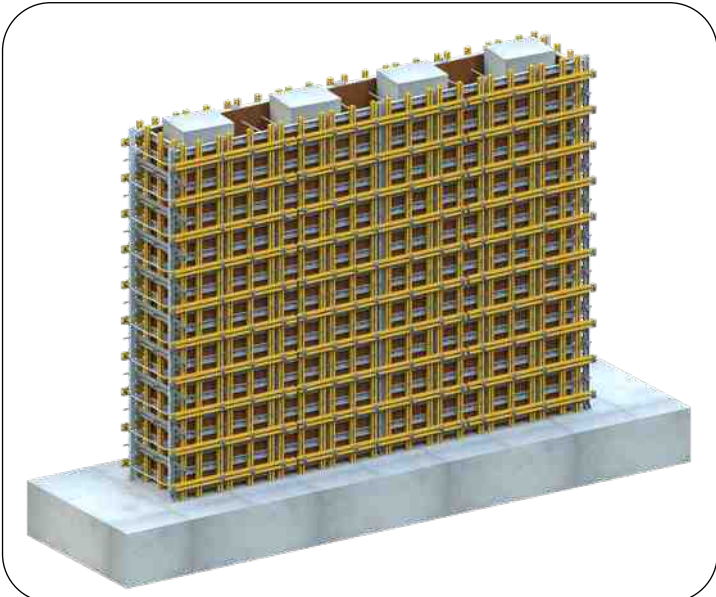

**1.9m high wall with out access and with alignment props shown**



**We work Worldwide all of our drawings and all structural calculations are available in Metric and Imperial measurements**



**6.4m high hand fit steel system for Google, London**



**Battered wing walls for Amco flood alleviation scheme**



**3.2m wall system for cow sheds in Lincolnshire**



**1.9m wall system in use on windfarm control building**



**Aluminium system in use on M6 Smart Motorway upgrade**



**1.9m / 2.4m & 3.2m in use on retaining wing wall**



**A small selection of walls, what ever your requirements we can design a solution for you and deliver it anywhere !**



# Delivery throughout the UK, Europe & Worldwide

We have designed & invested in specialist pallets for our products and smaller deliveries can be sent by a National & International palletised delivery network, we also run our own fleet of vehicles in the UK, for Europe & Worldwide sales please see our websites or contact your local dealer or distributor or just email us at [info@fastformsystems.com](mailto:info@fastformsystems.com)

- We are committed to keeping down the delivery costs and environmental impact of our deliveries, yet can still offer Next Day deliveries in the UK with a guaranteed timed delivery (dependant on stock)
- We have a fleet of fuel efficient vehicles for some of our deliveries including our Mercedes Benz Bluetec trucks & flatbeds all low emission vehicles including 3.5t / 7.5t & 26 tonne capacity.
- We are able to offer low cost delivery as our system is lighter than all the competition and so our delivery costs, emissions and Carbon footprint are LOWER.
- Our 26 tonne fleet also carry their own optional forklifts ( as shown below)

